



Express Toughening, 51-55 Fowler Road, Hainault, Essex, IG6 3UT

Tel: +44 (0)20 8500 1188
 info@expresstoughening.com
 www.expresstoughening.com

Copyright (C) - October 2020, All Rights Reserved

REQUIRED GLASS PREP

(Ø25mm HOLE - POSITIONING TO SUIT APPLICATION / DESIGN REQUIREMENTS)

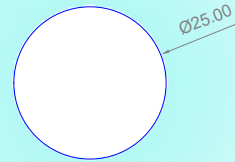

SIDE VIEW ON FITTING

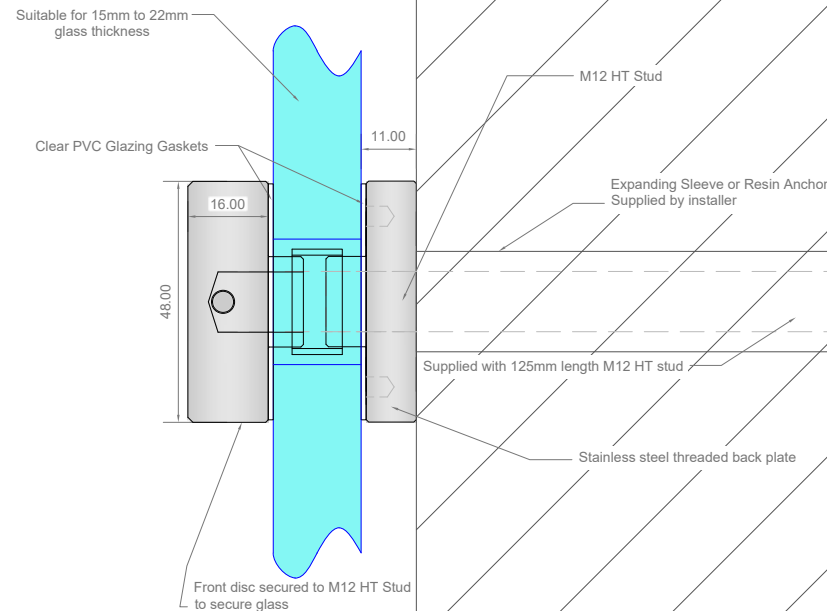

FRONT VIEW ON FITTING

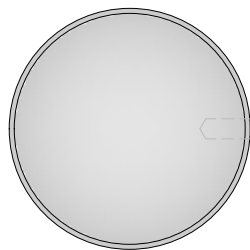

NOTE - RADIAL FINISHING LOCATION OF TIGHTENING HOLE WILL VARY BETWEEN FITTINGS.

NOTES/SPECIFICATION:

ALL FITTING COMPONENTS IN GRADE 316 MACHINED STAINLESS STEEL FINISH.

PRODUCT SUITABLE FOR 15mm TO 22mm TOUGHENED GLASS PANES.

FITTING SUPPLIED COMPLETE WITH:-

- 1) 2 No. x 1mm CLEAR PVC GLAZING WASHERS.
- 2) 1 No. ISOLATION TUBE
- 3) 125mm LENGTH M12 HT STUD

PRODUCT REF:	SH/ATB/GF03/XL
DESCRIPTION:	DIMENSIONED ELEVATIONS AND REQUIRED GLASS PREP DETAIL * AB - 25/04/18
DRAWING REF:	SH/ATB/GF03/XL - 001A